

Bootjack Fire Hall Bootjack, MI



SPECIFICATIONS:

Size: 7,950 sq. ft.
Completion: July 2010
Contact: Peter Dupuis
Phone: (906) 483-7917

PROJECT DESCRIPTION:

After several purchases of new equipment by Bootjack Fire and Rescue, the need to expand their current fire hall became a high priority. Bootjack Fire and Rescue turned to Division1 Design for design services of a new building that would be located next to their existing facility. The design of the new structure includes ample space for storing equipment out of the harsh winter conditions as well as additional offices and meeting rooms. The new building includes in-slab heating and multiple floor drains to quickly dry the rescue vehicles during the winter months. The exterior has an attractive masonry façade with glass overhead doors.

ENGINEERED TO ENSURE SUCCESS

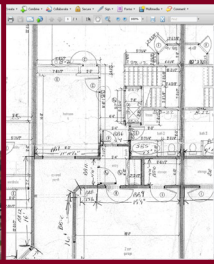

OUR SERVICES

Pre-Planning
Feasibility Studies
Site Analysis
Permitting
Surveying
Environmental Planning
Zoning

ARCHITECTURAL DESIGN

Master Planning
Conceptual Renderings
Design Drawings
Construction Drawings

ENGINEERING

Geotechnical
Structural
Civil

SUSTAINABLE DESIGN

Green building design as outlined by the U.S. Green Building Council
Brownfield Assistance

CONSTRUCTION DOCUMENTATION

Drawings
Specifications
Proposal forms

CONSTRUCTION PROCEDURES

On-site QC Inspections
Submittal Review
As-built Drawings
Cost Review

PROPERTY SURVEYING

Land Divisions
- Lot Splits
- Site Condominiums
- Platted Subdivisions
ALTA Land Title Surveys
Mortgage Surveys
Legal Descriptions

DESIGN/ENGINEERING SURVEYS

Topographic Surveys
- Site Design
- As built locations
Floodplain & Wetland Mapping

STAKING

Site Grading
Underground Utilities
Building Layout
Roadway Staking
GPS Machine Control
- Terrain Model Preparation
- Orientation and initialization of machine control equipment to site