

## Michigan Tech Employees Federal Credit Union Hancock, MI



### **SPECIFICATIONS:**

Size: 1,300 sq. ft.  
Completion: September 2008  
Contact: Ted Frederickson  
Phone: (906) 482-5005

### **PROJECT DESCRIPTION:**

Located in the Quincy Centre in Hancock, Michigan, the Michigan Tech Employees Federal Credit Union teamed with Division1 Design on their new Hancock branch. The facility incorporates a teller counter and lobby area along with loan offices, a conference room, and a break room area for employees. Site amenities include a drive-through window and a 24 hour ATM.

# ENGINEERED TO ENSURE SUCCESS

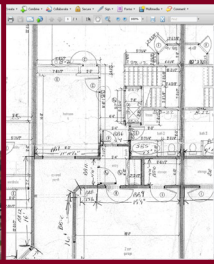

## OUR SERVICES

Pre-Planning  
Feasibility Studies  
Site Analysis  
Permitting  
Surveying  
Environmental Planning  
Zoning

## ARCHITECTURAL DESIGN

Master Planning  
Conceptual Renderings  
Design Drawings  
Construction Drawings

## ENGINEERING

Geotechnical  
Structural  
Civil

## SUSTAINABLE DESIGN

Green building design as  
outlined by the U.S.  
Green Building Council  
Brownfield Assistance

## CONSTRUCTION DOCUMENTATION

Drawings  
Specifications  
Proposal forms

## CONSTRUCTION PROCEDURES

On-site QC Inspections  
Submittal Review  
As-built Drawings  
Cost Review

## PROPERTY SURVEYING

Land Divisions  
- Lot Splits  
- Site Condominiums  
- Platted Subdivisions  
ALTA Land Title Surveys  
Mortgage Surveys  
Legal Descriptions

## DESIGN/ ENGINEERING SURVEYS

Topographic Surveys  
- Site Design  
- As built locations  
Floodplain & Wetland  
Mapping

## STAKING

Site Grading  
Underground Utilities  
Building Layout  
Roadway Staking  
GPS Machine Control  
- Terrain Model  
Preparation  
- Orientation and  
initialization of machine  
control equipment to site