

## Negaunee Retail Centre

Negaunee, Michigan



### **SPECIFICATIONS:**

Size: 30,000 sq. ft.

Completion: December 2006

Project Cost: \$590,000

Owner: Tim Aho

Phone: (906) 369-3708

### **PROJECT DESCRIPTION:**

Division1 Design was selected as the project engineer for the renovations of a grocery store that was to be converted into a retail center for multiple tenants. The work included a new façade for the building that provided each retail space with its own unique storefront. Aluminum storefronts and windows were added along with masonry and EIFS accents. On the interior of the building, the necessary utilities were brought into each space and a new floor poured. Division1 Design was also responsible for the site improvement designs including additional site drainage and parking lot layout.

# ENGINEERED TO ENSURE SUCCESS

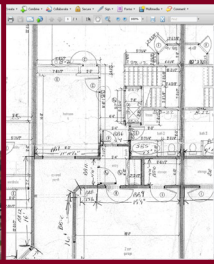

## OUR SERVICES

Pre-Planning  
Feasibility Studies  
Site Analysis  
Permitting  
Surveying  
Environmental Planning  
Zoning

## ARCHITECTURAL DESIGN

Master Planning  
Conceptual Renderings  
Design Drawings  
Construction Drawings

## ENGINEERING

Geotechnical  
Structural  
Civil

## SUSTAINABLE DESIGN

Green building design as  
outlined by the U.S.  
Green Building Council  
Brownfield Assistance

## CONSTRUCTION DOCUMENTATION

Drawings  
Specifications  
Proposal forms

## CONSTRUCTION PROCEDURES

On-site QC Inspections  
Submittal Review  
As-built Drawings  
Cost Review

## PROPERTY SURVEYING

Land Divisions  
- Lot Splits  
- Site Condominiums  
- Platted Subdivisions  
ALTA Land Title Surveys  
Mortgage Surveys  
Legal Descriptions

## DESIGN/ ENGINEERING SURVEYS

Topographic Surveys  
- Site Design  
- As built locations  
Floodplain & Wetland  
Mapping

## STAKING

Site Grading  
Underground Utilities  
Building Layout  
Roadway Staking  
GPS Machine Control  
- Terrain Model  
Preparation  
- Orientation and  
initialization of machine  
control equipment to site