

# Designed to Deliver Satisfaction

**Pamida** L'Anse, MI



## **SPECIFICATIONS:**

Size: 26,164 sq. ft.

Project Cost: \$1,873,000

Completion: March 2009

## **PROJECT DESCRIPTION:**

Working with a UP-based developer, Pamida selected a site for their new building along the US 41 Business District in L'Anse, Michigan. Division1 Design was brought on board with the design team to assist with the site design and permitting with local government agencies.

# ENGINEERED TO ENSURE SUCCESS

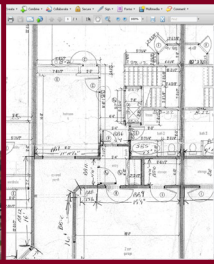

## OUR SERVICES

Pre-Planning  
Feasibility Studies  
Site Analysis  
Permitting  
Surveying  
Environmental Planning  
Zoning

## ARCHITECTURAL DESIGN

Master Planning  
Conceptual Renderings  
Design Drawings  
Construction Drawings

## ENGINEERING

Geotechnical  
Structural  
Civil

## SUSTAINABLE DESIGN

Green building design as outlined by the U.S. Green Building Council  
Brownfield Assistance

## CONSTRUCTION DOCUMENTATION

Drawings  
Specifications  
Proposal forms

## CONSTRUCTION PROCEDURES

On-site QC Inspections  
Submittal Review  
As-built Drawings  
Cost Review

## PROPERTY SURVEYING

Land Divisions  
- Lot Splits  
- Site Condominiums  
- Platted Subdivisions  
ALTA Land Title Surveys  
Mortgage Surveys  
Legal Descriptions

## DESIGN/ENGINEERING SURVEYS

Topographic Surveys  
- Site Design  
- As built locations  
Floodplain & Wetland Mapping

## STAKING

Site Grading  
Underground Utilities  
Building Layout  
Roadway Staking  
GPS Machine Control  
- Terrain Model Preparation  
- Orientation and initialization of machine control equipment to site