

River Valley Bank Calumet, MI



SPECIFICATIONS:

Location: Calumet, Michigan
Size: 5,000 sq. ft.
Completion: October 2007
Contact: Bob DuPont
Phone: (906) 337-0200

PROJECT DESCRIPTION:

Because of its location on the border of the Calumet Unit of the National Historic Park, this project required a design of a new building for River Valley Bank that would incorporate some of the local architectural features yet distinguish it from other structures. Exterior elements include brick, precast header and sill, an ornate cornice detail, and colors that complement other historical structures located in the Calumet Historical Park Unit. The interior space boasts high ceilings, dark wood trim details, and a tin style ceiling that is common in many of the local buildings. Division1 Design was a part of the design team for this successful project that includes all the modern amenities of a new facility with a façade which complements the area's history.

ENGINEERED TO ENSURE SUCCESS

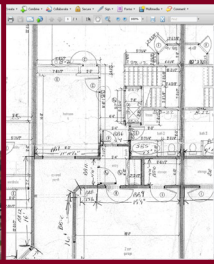

OUR SERVICES

Pre-Planning
Feasibility Studies
Site Analysis
Permitting
Surveying
Environmental Planning
Zoning

ARCHITECTURAL DESIGN

Master Planning
Conceptual Renderings
Design Drawings
Construction Drawings

ENGINEERING

Geotechnical
Structural
Civil

SUSTAINABLE DESIGN

Green building design as outlined by the U.S. Green Building Council
Brownfield Assistance

CONSTRUCTION DOCUMENTATION

Drawings
Specifications
Proposal forms

CONSTRUCTION PROCEDURES

On-site QC Inspections
Submittal Review
As-built Drawings
Cost Review

PROPERTY SURVEYING

Land Divisions
- Lot Splits
- Site Condominiums
- Platted Subdivisions
ALTA Land Title Surveys
Mortgage Surveys
Legal Descriptions

DESIGN/ENGINEERING SURVEYS

Topographic Surveys
- Site Design
- As built locations
Floodplain & Wetland Mapping

STAKING

Site Grading
Underground Utilities
Building Layout
Roadway Staking
GPS Machine Control
- Terrain Model Preparation
- Orientation and initialization of machine control equipment to site