

Tractor Supply Company

Negaunee, MI



SPECIFICATIONS:

Size: 14,880 sq. ft.
Project Cost: \$2,000,000
Completion: October 2008
Contact: Don Schwenn
Phone: (906) 369-3706

PROJECT DESCRIPTION:

Division1 Design was the engineer of record for the new Tractor Supply Company store in Negaunee, Michigan. Working with Tractor Supply's corporate design team, Division1 adapted the design to meet local building code requirements and weather considerations. The building design was for a pre-engineered metal building which provided ample open space for retail operations. A loading dock in the rear allows for material deliveries with minimal affect on store traffic. Because of display needs for certain pieces of equipment, a 15,000 square foot concrete slab was also included in the design. This area was fenced off to provide the store with a secure, yet functional area for displaying new merchandise during summer months.

Project Includes:

- 15,000 sq. ft. exterior display area

ENGINEERED TO ENSURE SUCCESS

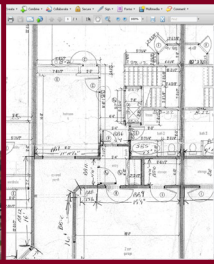

OUR SERVICES

Pre-Planning
Feasibility Studies
Site Analysis
Permitting
Surveying
Environmental Planning
Zoning

ARCHITECTURAL DESIGN

Master Planning
Conceptual Renderings
Design Drawings
Construction Drawings

ENGINEERING

Geotechnical
Structural
Civil

SUSTAINABLE DESIGN

Green building design as
outlined by the U.S.
Green Building Council
Brownfield Assistance

CONSTRUCTION DOCUMENTATION

Drawings
Specifications
Proposal forms

CONSTRUCTION PROCEDURES

On-site QC Inspections
Submittal Review
As-built Drawings
Cost Review

PROPERTY SURVEYING

Land Divisions
- Lot Splits
- Site Condominiums
- Platted Subdivisions
ALTA Land Title Surveys
Mortgage Surveys
Legal Descriptions

DESIGN/ ENGINEERING SURVEYS

Topographic Surveys
- Site Design
- As built locations
Floodplain & Wetland
Mapping

STAKING

Site Grading
Underground Utilities
Building Layout
Roadway Staking
GPS Machine Control
- Terrain Model
Preparation
- Orientation and
initialization of machine
control equipment to site